

PILASTRI



serio prefabbricati

Le dimensioni dei pilastri sono variabili da 40x40 a 80x80

Inserimento di pluviali per lo scarico delle acque piovane \varnothing variabile

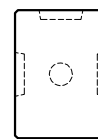
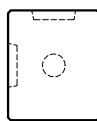
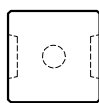
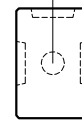
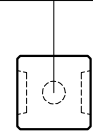

E' possibile creare nicchie per l'inserimento dei tamponamenti

E' possibile eseguire mensole di svariate dimensioni e a qualsiasi quota

